

PRODUCT INFORMATION PACKET



Model No: 056T11O5309

Catalog No: X526

Condenser Fan Motor, 2 HP, 3 Ph, 60 Hz, 575 V, 1200 RPM, 56Z Frame, OPAO



Regal and LEESON are trademarks of Regal Rexnord Corporation or one of its affiliated companies.
©2025 Regal Rexnord Corporation, All Rights Reserved. MC017097E





Nameplate Specifications

Phase	3	Output HP	2 Hp
Output KW	1.5 kW	Voltage	575 V
Speed	1140 rpm	Service Factor	1.0
Frame	56Z	Enclosure	Open Air Over
Thermal Protection	Automatic	Efficiency	81.5 %
Ambient Temperature	70 °C	Frequency	60 Hz
Current	2.7 A	Power Factor	67
Duty	Continuous	Insulation Class	H
Design Code	NO DESIGN CODE	KVA Code	J
Drive End Bearing Size	6203	Opp Drive End Bearing Size	6203
UL	Recognized (Not Protector)	CSA	Y
CE	N	IP Code	10
Number of Speeds	1		

Technical Specifications

Electrical Type	Squirrel Cage Induction Run	Starting Method	Across The Line
Poles	6	Rotation	Reversible
Resistance Main	9 Ohms	Mounting	Round Belly Band
Motor Orientation	Shaft Up	Drive End Bearing	Ball
Opp Drive End Bearing	Ball	Frame Material	Rolled Steel
Shaft Type	Single Special Extension	Overall Length	16.68 in
Frame Length	9.56 in	Shaft Diameter	0.625 in
Shaft Extension	5.06 in	Assembly/Box Mounting	F1 ONLY
Outline Drawing	A-100153-956	Connection Drawing	A-EE7335B

This is an uncontrolled document once printed or downloaded and is subject to change without notice. Date Created:08/06/2025

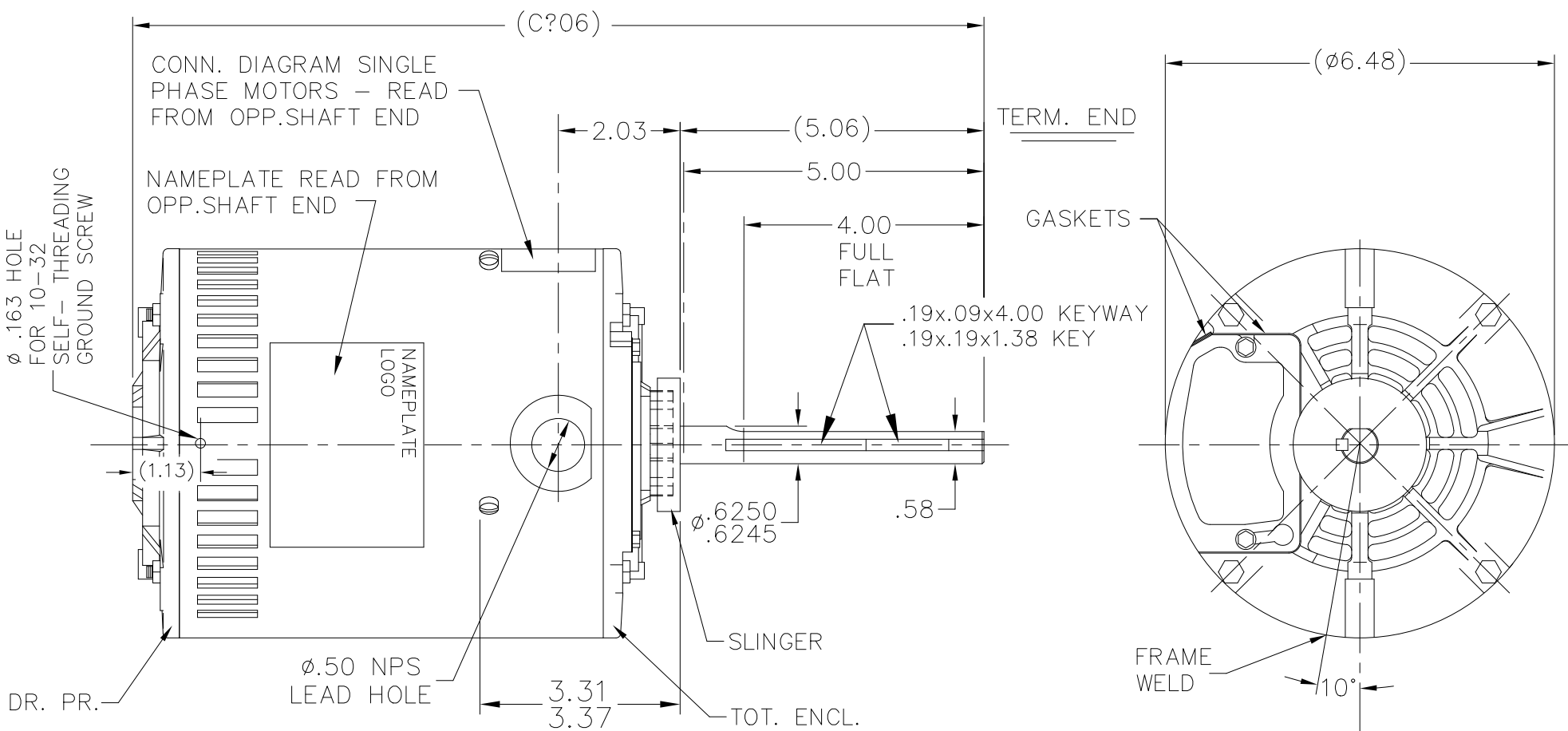

DASH	FRAME	C	DASH	FRAME	C
656	56-65	13.68	856	56-85	15.68
706	"-70	14.18	906	"-90	16.18
756	"-75	14.68	956	"-95	16.68
806	"-80	15.18			

NO.	REVISION	BY & DATE	CHK	TOLERANCES UNLESS SPECIFIED	
				DEC.	INCHES
8	CHG FROM MARATHON TO REGAL REXNORD LOGO	KVDG 05-10-2024	DS	.X	±.1
7	ADDED LOCATING SCREWS ISAAC 07-1469	RJW 08-31-2007	EH	.XX	±.03
6	REDRAWN IN AUTOCAD	TAT 08-03-2004	ML	.XXX	±.005
5	REDRAWN ON CADD	MJD 04-02-1998		.XXXX	±.0005
			ANG		±7'30"

Regal Rexnord Regal Beloit America, Inc.

TITLE OUTLINE
56 FR.

MAT'L.

FINISH

DRAWN MJD 03-27-1998
CHK ML 04-02-1998
APPD GK 04-02-1998
SCALE 3=8
REF
FMF
PREV

SINGLE VOLTAGE – THREE PHASE WITH OVERLOAD PROTECTOR

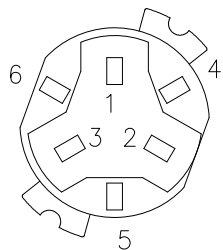

NOTE:
ACTUAL PROTECTORS
TERMINAL LOCATIONS
FOR LEAD CONNECTIONS

NOTE: TERMINAL BOARD
CONNECTIONS

LEADS WITH TERMINALS
SHOULD BE CONNECTED
TO INBOARD SIDE OF
TERMINAL BOARD.

T1 ---	L1 —	4A	} IF REQUIRED
T2 ---	L2 —	5A	
T3 ---	L3 —	6A	

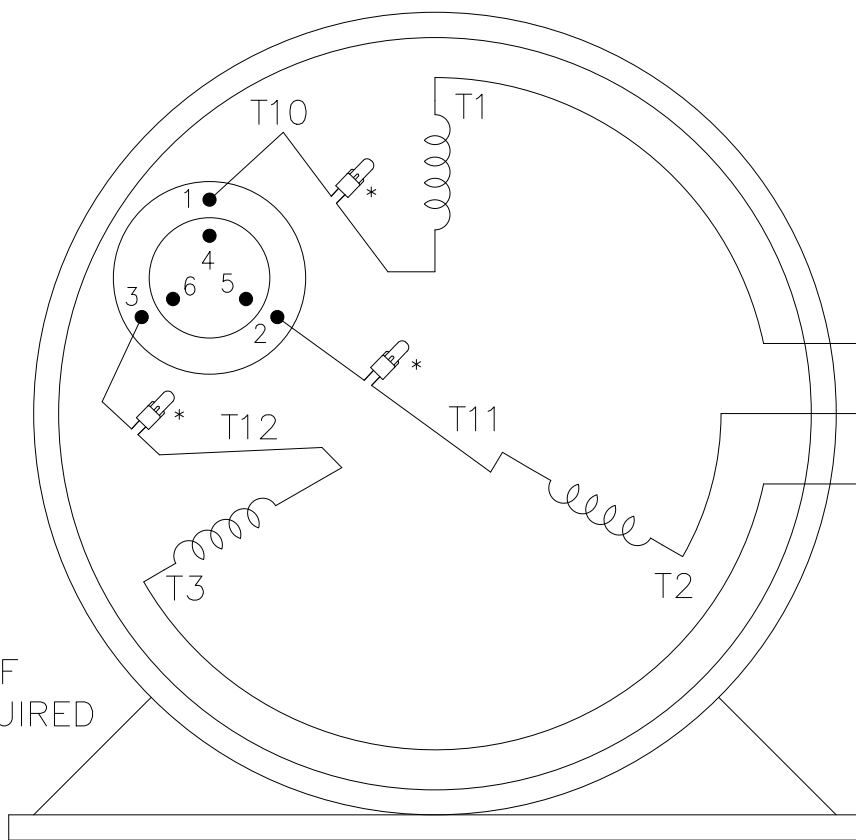

T1	—	4A	} IF REQUIRED
T2	—	5A	
T3	—	6A	

IF
REQUIRED

—TO REVERSE ROTATION—
INTERCHANGE ANY TWO
LINE LEAD CONNECTIONS

VIEW OF TERMINAL END

OPTIONAL CORD
CONNECTION

L1	—	WHITE
L2	—	RED
L3	—	BLACK

		T6CK
T6CA		T6BM
T4CC		T4AY
T4C		T2DL
T6D		T2H

* USE PRESSURE CONNECTORS FOR MT2 PLANT ONLY

NO.	REVISION	BY & DATE	CHK	TOLERANCES UNLESS SPECIFIED		FINISH	DRAWN KL 08-25-1993
				DEC.	INCHES		
12	UPDATED PER ECR-0211312	SG 07/27/2021	BD	.X	± -		CHK RD 11-12-2014
11	ADDED THE OPTIONAL CORD CONNECTION	JAH 11-12-2014	RD	.XX	± -	TITLE CONNECTION DIAGRAM	APPD RD 11-12-2014
10	PRESSURE CONNECTORS ADDED (QTY 3)	PVR 07-09-2014	GR	.XXX	± -	SINGLE VOLT – 3Ø WITH OVERLOAD PROT.	SCALE 1=1
9	ADDED 4A, 5A, & 6A "IF REQUIRED" MU44987	MSG 01-07-2002	SAS	.XXXX	± -	MAT'L.	REF
				ANG	± -		FMF



THIS DRAWING IN DESIGN AND DETAIL IS OUR PROPERTY AND MUST NOT BE USED EXCEPT IN CONNECTION WITH OUR WORK ALL RIGHTS OF DESIGN AND INVENTION ARE RESERVED THIS IS AN ELECTRONICALLY GENERATED DOCUMENT – DO NOT SCALE THIS PRINT

RFP
DIST LB-WP
CAD FILE EE7335B

SIZE	DRAWING NO.	PAGE	OF	REV.
A	EE7335B			12



REGAL REXNORD CORPORATION
TYPICAL PERFORMANCE CURVE for AC MOTOR

Customer

Curve at

575

Volts

HP 2.00

PHASE 3

Model No 56T1105309

60

HZ

VOLTS 575

Catalog No X526

2

HP

HZ 60

RPM 1140

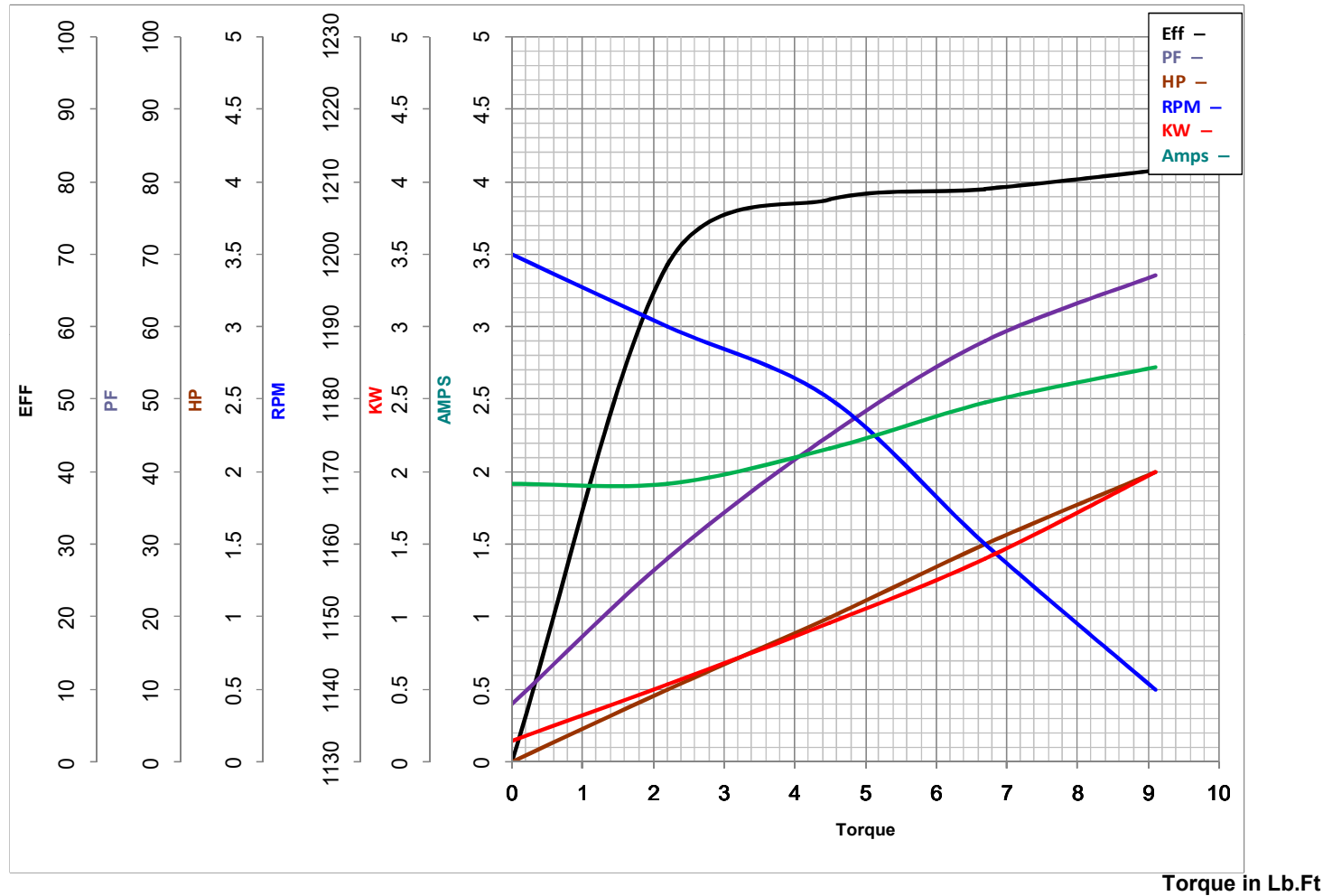

Torque in Lb.Ft

FL TORQUE 9.1 Lb.Ft
BD TORQUE 29.5 Lb.Ft
LR TORQUE 25.6 Lb.Ft

FL AMPS 2.7
PU TORQUE 26.0 Lb.Ft
LR AMPS 15.84

WINDING ZT600-2

Date 1/23/2019