

# PRODUCT INFORMATION PACKET



Model No: B383

Catalog No: B383

Air Compressor Motor, 3SPL HP, 1 Ph, 60 Hz, 115/230 V, 3600 RPM, U56None Frame, DP



Regal and Century are trademarks of Regal Rexnord Corporation or one of its affiliated companies.  
©2025 Regal Rexnord Corporation, All Rights Reserved. MC017097E





**Nameplate Specifications**

|                    |                     |                     |            |
|--------------------|---------------------|---------------------|------------|
| Phase              | 1                   | Output HP           | 3SPL Hp    |
| Output KW          | 2.2 kW              | Voltage             | 115/230 V  |
| Speed              | 3450 rpm            | Service Factor      | 1.00       |
| Frame              | U56None             | Enclosure           | Drip Proof |
| Thermal Protection | Thermally Protected | Ambient Temperature | 40 °C      |
| Frequency          | 60 Hz               | Current             | 15.0/7.5 A |
| Duty               | Continuous          | Insulation Class    | B          |
| UL                 | Recognized          | CSA                 | Y          |
| CE                 | N                   | Number of Speeds    | 1          |

**Technical Specifications**

|                       |  |                   |                 |
|-----------------------|--|-------------------|-----------------|
| Electrical Type       | Capacitor Start, Capacitor Run, Single Or Dual Voltage | Starting Method   | Across The Line |
| Poles                 | 2  | Rotation          | Clockwise       |
| Mounting              | Rigid Base   | Drive End Bearing | Ball            |
| Opp Drive End Bearing | Ball   | Frame Material    | Rolled Steel    |
| Shaft Type            | Keyed  | Overall Length    | 11.59 in        |
| Frame Length          | 7.00 in  | Shaft Diameter    | 0.625 in        |
| Shaft Extension       | 1.94 in  |                   |                 |
| Connection Drawing    | 17050305.PCX   | Outline Drawing   | 174176-S01      |

This is an uncontrolled document once printed or downloaded and is subject to change without notice. Date Created:03/09/2025

| GRP. NO. | TYPE | FRAME SIZE | FORM | 'C'          | 'BS'        |
|----------|------|------------|------|--------------|-------------|
| 01       | CP   | U56        | K    | 11.59[294.4] | 5.52[140.2] |
| 02       | CP   | X56        | K    | 12.09[307.1] | 6.02[152.9] |

| REV | ECO         | REV BY        | DATE       | APPD | DATE |
|-----|-------------|---------------|------------|------|------|
| G   | ECR-0213452 | D.SURYAWANSHI | 10/28/2021 |      |      |

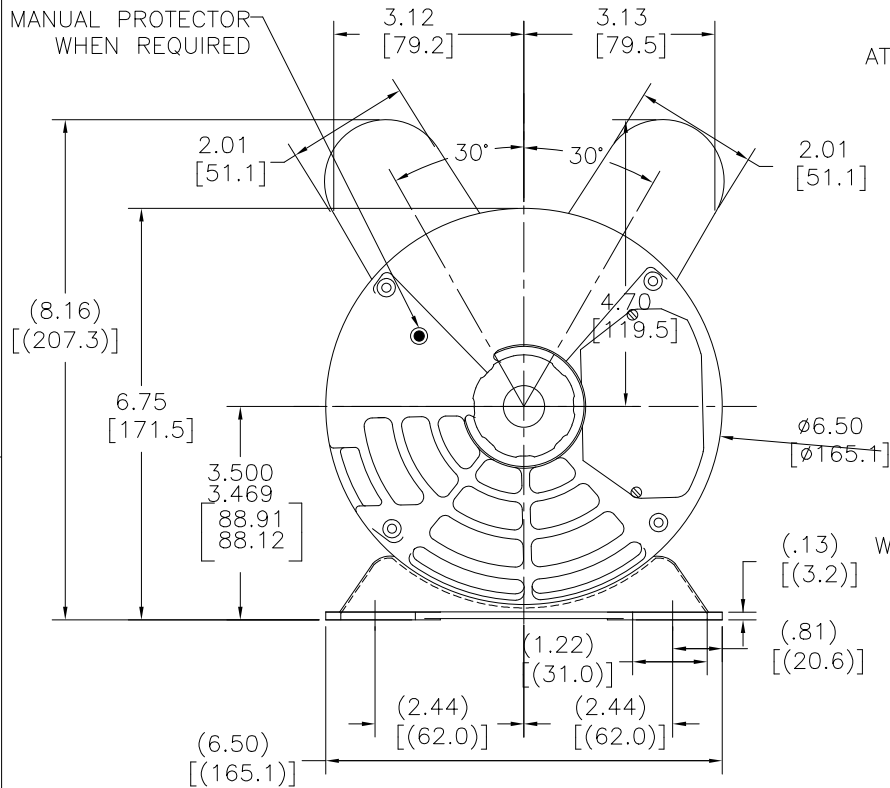

NAMEPLATE AT 3.00 O'CLOCK

1/2-14 NPSM WITH PLUG WHEN REQUIRED

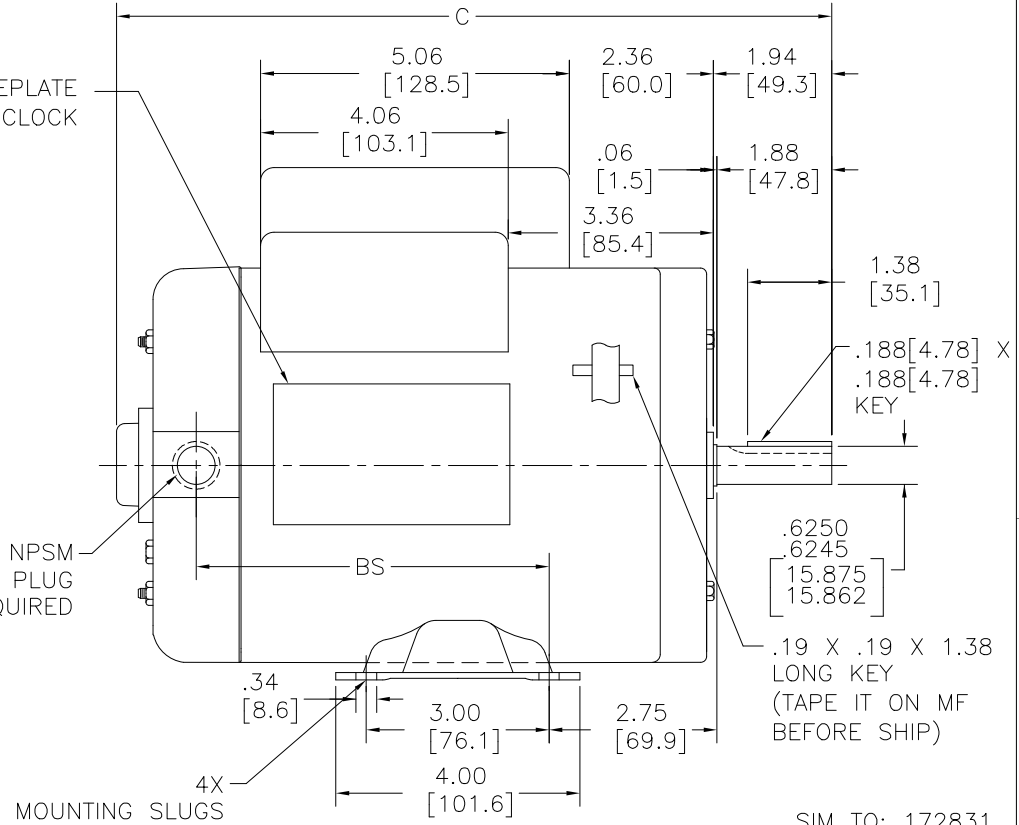

SIM TO: 172831

GEOMETRIC CHARACTERISTICS & SYMBOLS

- ▭ FLATNESS
- STRAIGHTNESS
- ∠ ANGULARITY
- ⊥ PERPENDICULARITY (SQUARENESS)
- // PARALLELISM
- ROUNDNESS (CIRCULARITY)
- ⊘ CYLINDRICITY
- △ PROFILE OF ANY SURFACE
- ⌒ PROFILE OF ANY LINE
- ↑ RUNOUT
- ⊕ TRUE POSITION
- ◎ CONCENTRICITY
- ≡ SYMMETRY

ASME Y14.5M 1994

UNLESS OTHERWISE SPECIFIED DIM. TOLERANCES ARE AS FOLLOWS:

INCH X XX XXX XXXX  
 mm ±0.1 ±0.02 ±0.005 ±0.0005  
 mm ±0.5 ±0.13 ±0.013

ANG. ±.50 DEG  
 REMOVE BURRS & BREAK SHARP EDGES:  
 INCH .003-.015 mm 0.1-0.4

CORNER FILLETS TO:  
 INCH .020 mm 0.5

MACHINE SURFACES:  
 INCH 125 mm 3.2

METRIC DIMS. SHOWN IN [BRACKETS]

DR BY: SAS 12-16-1986

APPD: MS 12-18-1986

THIRD ANGLE PROJECTION

EDS DATE 11-11-2011  
 FORMAT REV G

CONFIDENTIAL: THIS DRAWING AND ITS INFORMATION ARE THE EXCLUSIVE AND CONFIDENTIAL PROPERTY OF REGAL-BELOIT CORPORATION AND ARE NOT TO BE DISCLOSED, DUPLICATED, DISTRIBUTED OR OTHERWISE USED WITHOUT THE WRITTEN CONSENT OF REGAL-BELOIT CORPORATION. -ALL RIGHTS RESERVED.

**REGAL-BELOIT CORPORATION**

DESCRIPTION: MODEL-CFHP-56FR OUTLINE

SIZE: B DWG NO: 174176

SCALE: NONE SHEET: 1