

PRODUCT INFORMATION PACKET



Model No: C595
Catalog No: C595

General Purpose Farm Duty Motor, 1.5-.44 HP, 1 Ph, 60 Hz, 115 V, 1800 RPM, P56H Frame, TEAO



Regal and Century are trademarks of Regal Rexnord Corporation or one of its affiliated companies.
©2022 Regal Rexnord Corporation, All Rights Reserved. MC017097E





Nameplate Specifications

Output HP	1.5-.44 Hp	Output KW	1.1 kW
Frequency	60 Hz	Voltage	115 V
Current	15.6/9.1 A	Speed	1725/1140 rpm
Service Factor	1	Phase	1
Duty	Continuous	Insulation Class	B
Frame	P56H	Enclosure	Totally Enclosed Air Over
Thermal Protection	Thermally Protected	Ambient Temperature	40 °C
UL	Recognized	CSA	Y
CE	N	Number of Speeds	2-2-VT

Technical Specifications

Electrical Type	Permanent Split Capacitor, High Speed; Split Phase, Low Speed	Starting Method	Across The Line
Poles	4/6	Rotation	Reversible Counterclockwise
Mounting	Rigid Base	Drive End Bearing	Ball
Opp Drive End Bearing	Ball	Frame Material	Rolled Steel
Shaft Type	Keyed	Overall Length	13.94 in
Frame Length	8.00 in	Shaft Diameter	0.625 in
Shaft Extension	1.94 in		
Connection Drawing	17050725.PCX	Outline Drawing	174085-S01

This is an uncontrolled document once printed or downloaded and is subject to change without notice. Date Created:11/29/2022

ALL DIMENSIONS SHOWN IN PARENTHESIS ARE REFERENCE DIMENSIONS. ALL OTHER DIMENSIONS ARE TOLERANCED PER THE FOLLOWING CHART UNLESS OTHERWISE SPECIFIED.

"C" DIM. = +/- .055
 SHAFT EXT. = +/- .034
 LEAD LENGTHS = +/- 1.00
 EXTENDED THRU-BOLTS = +/- .050
 ANGULAR DIM. = +/- 2°

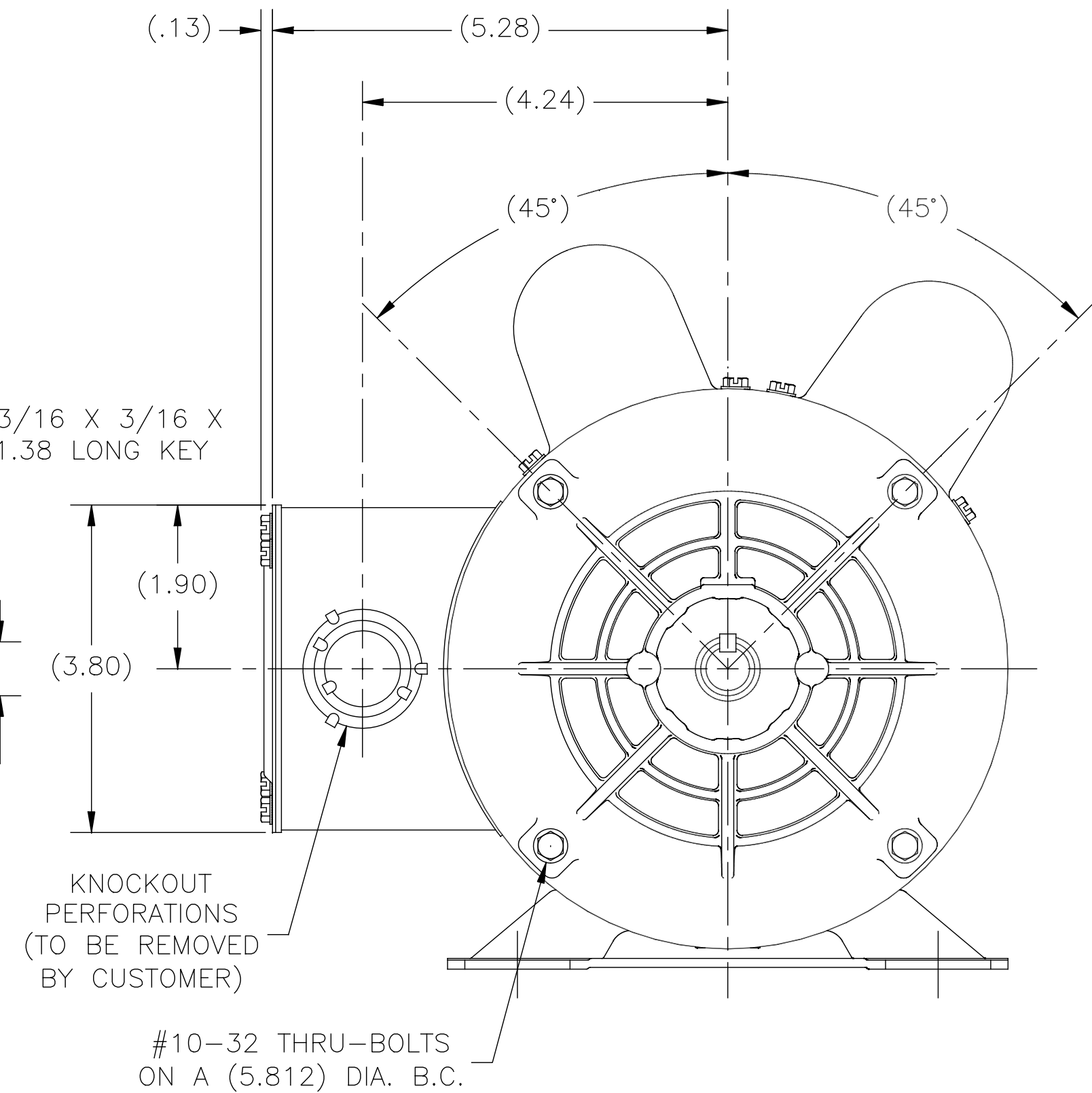
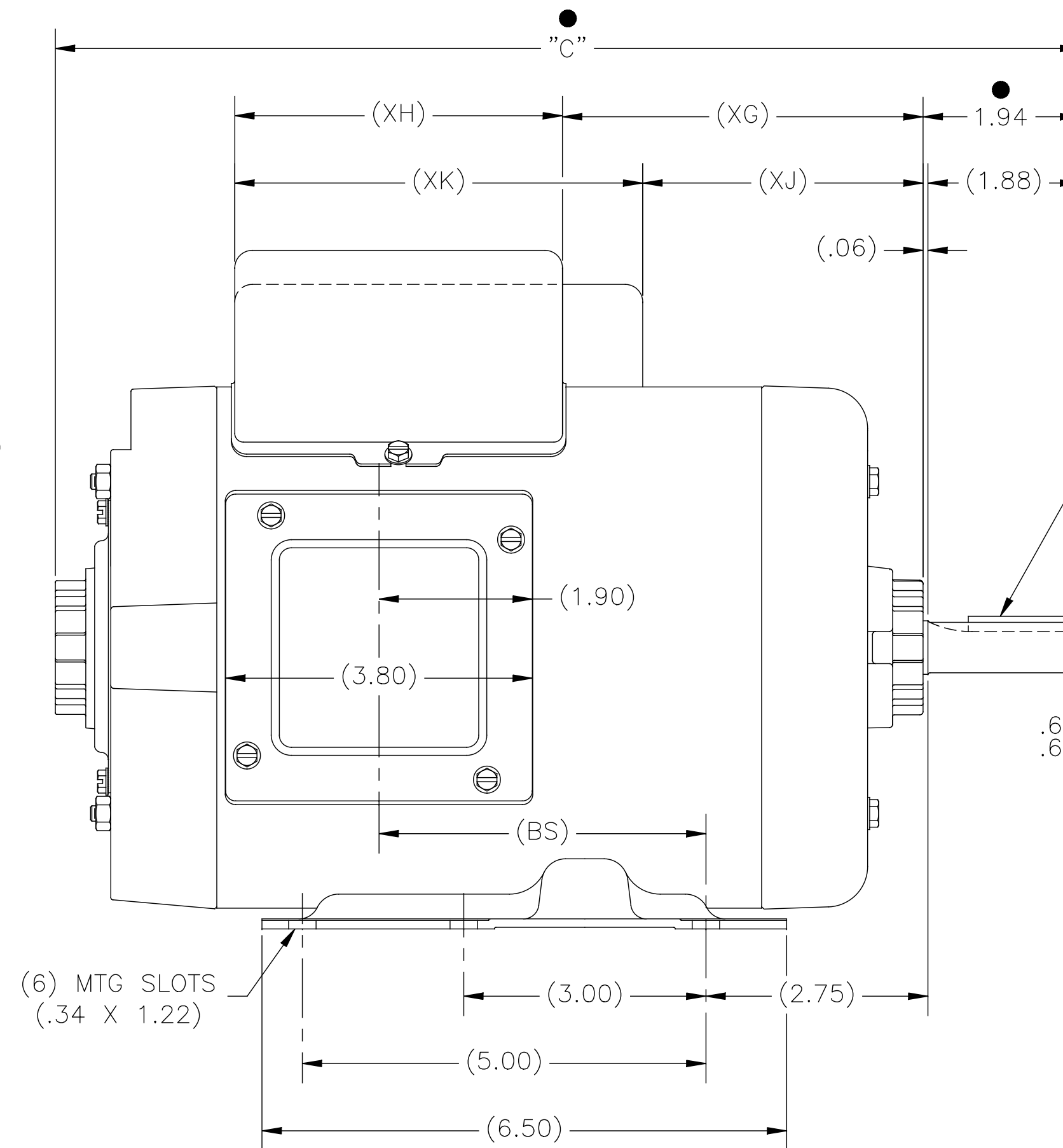
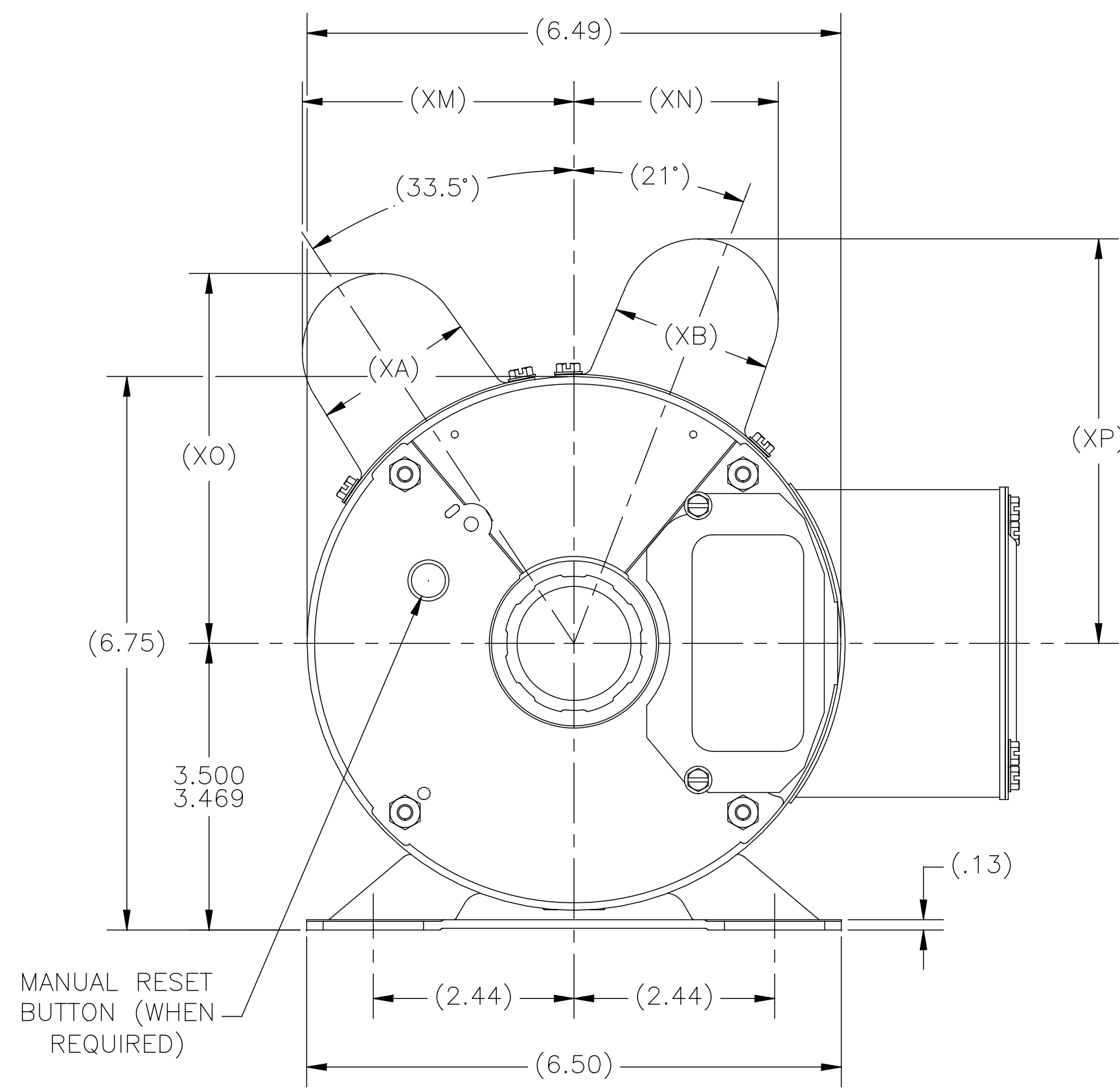

-03														
-02														
-01	CP	P56H	13.94	5.31	2.01	1.64	5.71	4.08	4.72	5.06	3.31	2.25	4.50	4.60
GROUP	TYPE	FRAME	"C"	(BS)	(XA)	(XB)	(XG)	(XH)	(XJ)	(XK)	(XM)	(XN)	(XO)	(XP)

DRAWING REVISION E00	REVISION BY A. LITTLE/JOHN	DATE 08-08-2016	TOLERANCES UNLESS OTHERWISE SPECIFIED DEC INCH mm ANGLE	DRAWN BY FILM
0098990	J. HESS	08-12-2016	.X ±0.1 [±2.5] ±0.5°	DATE 12-15-1986
000 DESCRIPTION THRU-BOLT CHANGE			.XX ±0.02 [±0.51]	APPROVED BY MH
			.XXX ±0.005 [±0.127]	DATE 01-06-1987
			.XXXX ±0.0005 [±0.0127]	REFERENCE
			REMOVE BURRS & BREAK SHARP EDGES .003/.015 [0.076/.381]	DESCRIPTION MODEL-CFHP-56FR OUTLINE
			CORNER FILLETS .02 [51]	MATERIAL
			MACHINED SURFACES .001 INCH .025 mm	PROCESS/FINISH
			mm SHOWN IN [BRACKETS]	SIZE DWG NO 174085
			THIRD ANGLE PROJECTION	SHEET 1