

# PRODUCT INFORMATION PACKET



Model No: H279  
Catalog No: H279  
1/2,1140,DP,56,3/60/200-230/460  
General Purpose Motors



Regal and Century are trademarks of Regal Rexnord Corporation or one of its affiliated companies.  
©2021 Regal Rexnord Corporation, All Rights Reserved. MC017097E





### Nameplate Specifications

Output HP	1/2 Hp	Output KW	0.37 kW
Frequency	60 Hz	Voltage	200-230/460 V
Current	2.0-1.9/.95 A	Speed	1140 rpm
Service Factor	1.25	Phase	3
Duty	Continuous	Insulation Class	B
Frame	J56	Enclosure	Drip Proof
Thermal Protection	None	Ambient Temperature	40 °C
UL	Recognized	CSA	Y
CE	N	Number of Speeds	1

### Technical Specifications

Electrical Type	Polyphase, Induction Type, Single Or Dual Voltage	Starting Method	Across The Line
Poles	6	Rotation	Reversible Counterclockwise
Mounting	Rigid Base	Drive End Bearing	Ball
Opp Drive End Bearing	Ball	Frame Material	Rolled Steel
Shaft Type	Keyed	Overall Length	11.70 in
Frame Length	5.13 in	Shaft Diameter	0.625 in
Shaft Extension	1.94 in		
Outline Drawing	114012-S01	Connection Drawing	17050706.PCX

This is an uncontrolled document once printed or downloaded and is subject to change without notice. Date Created:10/11/2021

TYPE	FRAME	MOTOR		CAPACITOR BOX			
		C	BS	XA	XG	XH	XN
CS SP SC	B56	9.82 [249.4]	3.75 [95.3]	1.64 [41.7]	1.59 [40.4]	4.08 [103.6]	8.37 [212.6]
CS SP SC	H56	10.07 [255.8]	4.00 [101.6]	1.64 [41.7]	1.84 [46.7]	4.08 [103.6]	8.37 [212.6]
CS SP SC	J56	11.07 [281.2]	5.00 [127.0]	1.64 [41.7]	2.84 [72.1]	4.08 [103.6]	8.37 [212.6]
CS SP SC	K56	11.44 [290.6]	5.38 [136.7]	1.64 [41.7]	3.21 [81.5]	4.08 [103.6]	8.37 [212.6]
CS SP SC	L56	12.19 [309.6]	6.13 [155.7]	1.64 [41.7]	3.96 [100.6]	4.08 [103.6]	8.37 [212.6]
CS SP SC	M56	12.69 [322.3]	6.63 [168.4]	2.02 [51.3]	4.46 [113.3]	4.08 [103.6]	8.75 [222.3]

REV	ECO	REV BY	DATE	APPD	DATE
T	0036702	M.AVILA	08-12-2013	M.AVILA	08-12-2013

ALL DIMENSIONS SHOWN IN PARENTHESIS ARE REFERENCE DIMENSIONS. ALL OTHER DIMENSIONS ARE TOLERANCED PER THE FOLLOWING CHART UNLESS OTHERWISE SPECIFIED.

"C" DIM. = +/- .055[1.40]  
 SHAFT EXT. = +/- .034[.86]  
 LEAD LENGTHS = +/- 1.00[25.4]  
 EXTENDED THRU-BOLTS = +/- .050[1.27]  
 ANGULAR DIMS. = +/- 2'

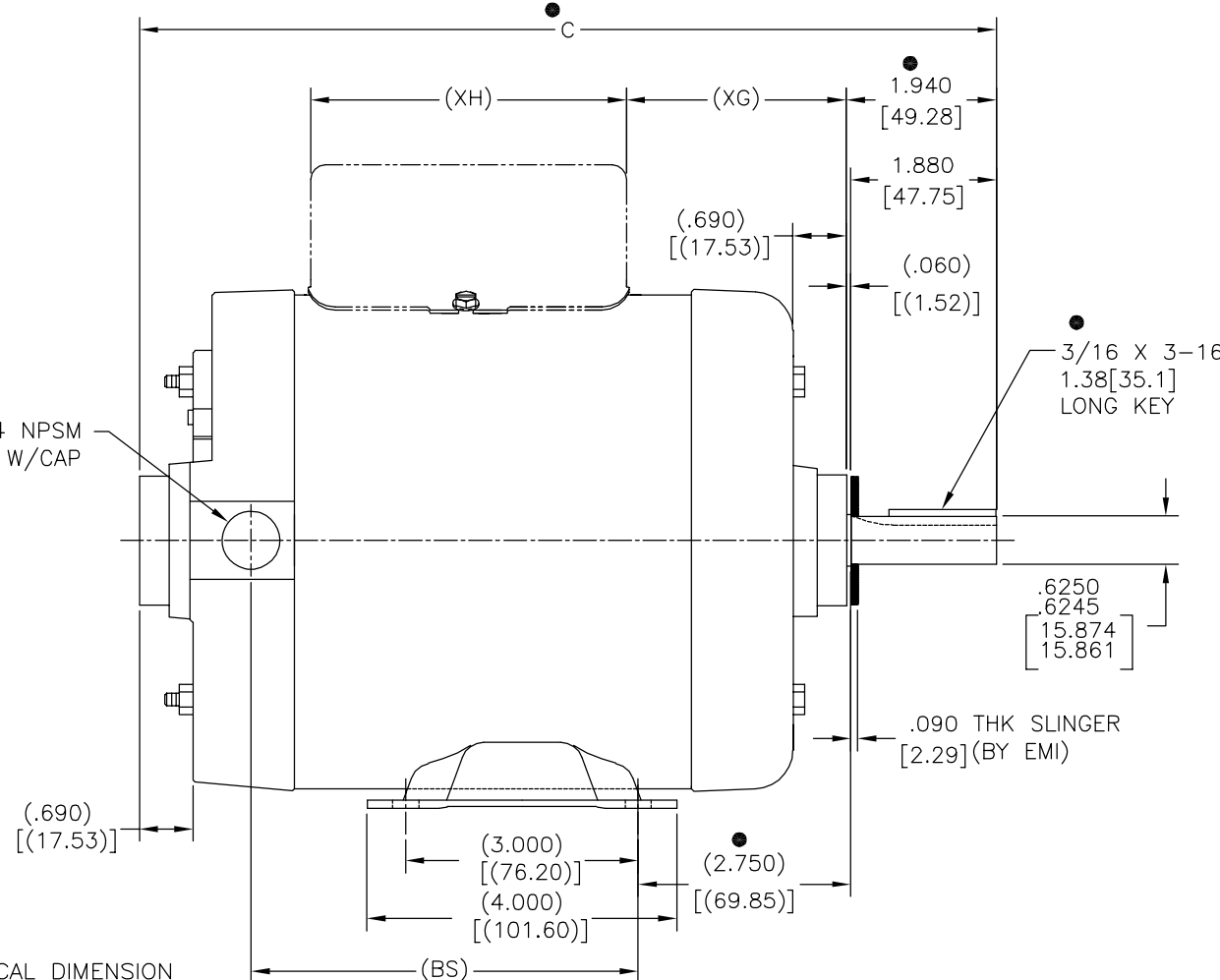
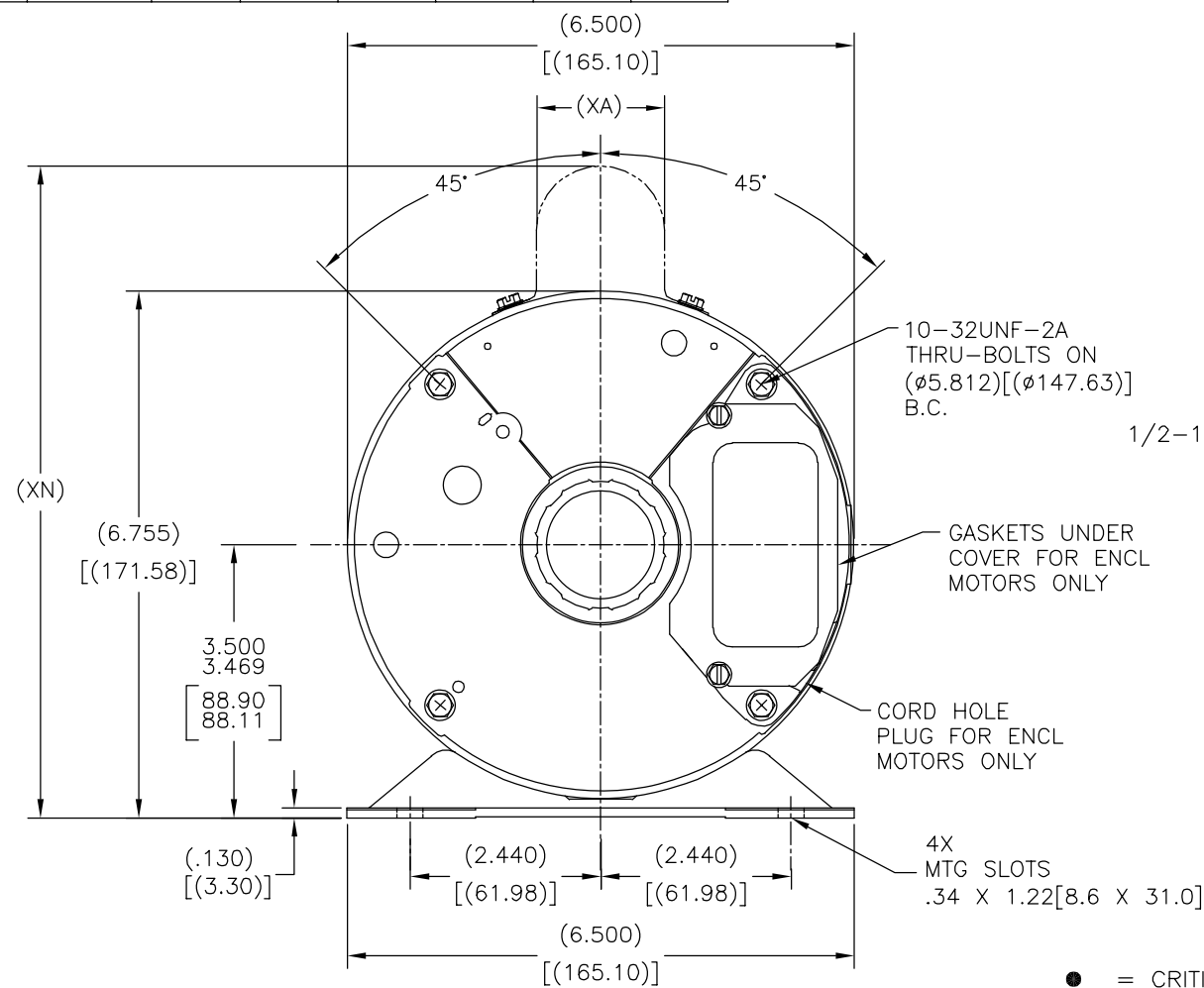

● = CRITICAL DIMENSION

GEOMETRIC CHARACTERISTICS & SYMBOLS

- ▭ FLATNESS
- STRAIGHTNESS
- ∠ ANGULARITY
- ⊥ PERPENDICULARITY (SQUARENESS)
- // PARALLELISM
- ROUNDNESS (CIRCULARITY)
- ⊘ CYLINDRICITY
- △ PROFILE OF ANY SURFACE
- ∩ PROFILE OF ANY LINE
- ↯ RUNOUT
- ⊕ TRUE POSITION
- ◎ CONCENTRICITY
- ≡ SYMMETRY

ASME Y14.5M 1994

UNLESS OTHERWISE SPECIFIED DIM. TOLERANCES ARE AS FOLLOWS:

INCH X XX XXX XXXX  
 ±.1 ±.02 ±.005 ±.0005  
 mm ±0.5 ±0.13 ±0.013

ANG. ±.50 DEG  
 REMOVE BURRS & BREAK SHARP EDGES:  
 INCH .003-.015 mm 0.1-0.4

CORNER FILLETS TO:  
 INCH .020 mm 0.5

MACHINE SURFACES:  
 INCH 125 mm 3.2

METRIC DIMS. SHOWN IN [BRACKETS]

DR BY:

APPD:

THIRD ANGLE PROJECTION

EDS DATE 11-11-2011  
 FORMAT REV H

CONFIDENTIAL: THIS DRAWING AND ITS INFORMATION ARE THE EXCLUSIVE AND CONFIDENTIAL PROPERTY OF REGAL-BELOIT CORPORATION AND ARE NOT TO BE DISCLOSED, DUPLICATED, DISTRIBUTED OR OTHERWISE USED WITHOUT THE WRITTEN CONSENT OF REGAL-BELOIT CORPORATION. -ALL RIGHTS RESERVED.

**REGAL REGAL-BELOIT CORPORATION**

DESCRIPTION: MODEL-DC OUTLINE

SIZE: C DWG NO: 114012

SCALE: NONE SHEET: 1

4

3

2

1

TIPO	CARCAZA	MOTOR		CAJA DEL CAPACITOR			
		C	BS	XA	XG	XH	XN
CS SP SC	B56	9.82 [249.4]	3.75 [95.3]	1.64 [41.7]	1.59 [40.4]	4.08 [103.6]	8.37 [212.6]
CS SP SC	H56	10.07 [255.8]	4.00 [101.6]	1.64 [41.7]	1.84 [46.7]	4.08 [103.6]	8.37 [212.6]
CS SP SC	J56	11.07 [281.2]	5.00 [127.0]	1.64 [41.7]	2.84 [72.1]	4.08 [103.6]	8.37 [212.6]
CS SP SC	K56	11.44 [290.6]	5.38 [136.7]	1.64 [41.7]	3.21 [81.5]	4.08 [103.6]	8.37 [212.6]
CS SP SC	L56	12.19 [309.6]	6.13 [155.7]	1.64 [41.7]	3.96 [100.6]	4.08 [103.6]	8.37 [212.6]
CS SP SC	M56	12.69 [322.3]	6.63 [168.4]	2.02 [51.3]	4.46 [113.3]	4.08 [103.6]	8.75 [222.3]

REVISION:	ECO	REVISADO POR:	FECHA:	APROBADO POR:	FECHA:
T	0036702	M.AVILA	08-12-2013	M.AVILA	08-12-2013

TODAS LAS DIMENSIONES MOSTRADAS ENTRE PARENTESIS SON DIMENSIONES DE REFERENCIA. TODAS LAS DEMAS DIMENSIONES TIENEN TOLERANCIA DE ACUERDO A LA SIGUIENTE TABLA A MENOS QUE SE ESPECIFIQUE LO CONTRARIO.

"C" DIM.	= +/- .055[1.40]
EXTENSION DE FLECHA	= +/- .034[.86]
LONGITUD DE CABLES	= +/- 1.00[25.4]
EXTENSION DE PERNO PASADO	= +/- .050[1.27]
DIMENSION ANGULAR	= +/- 2'

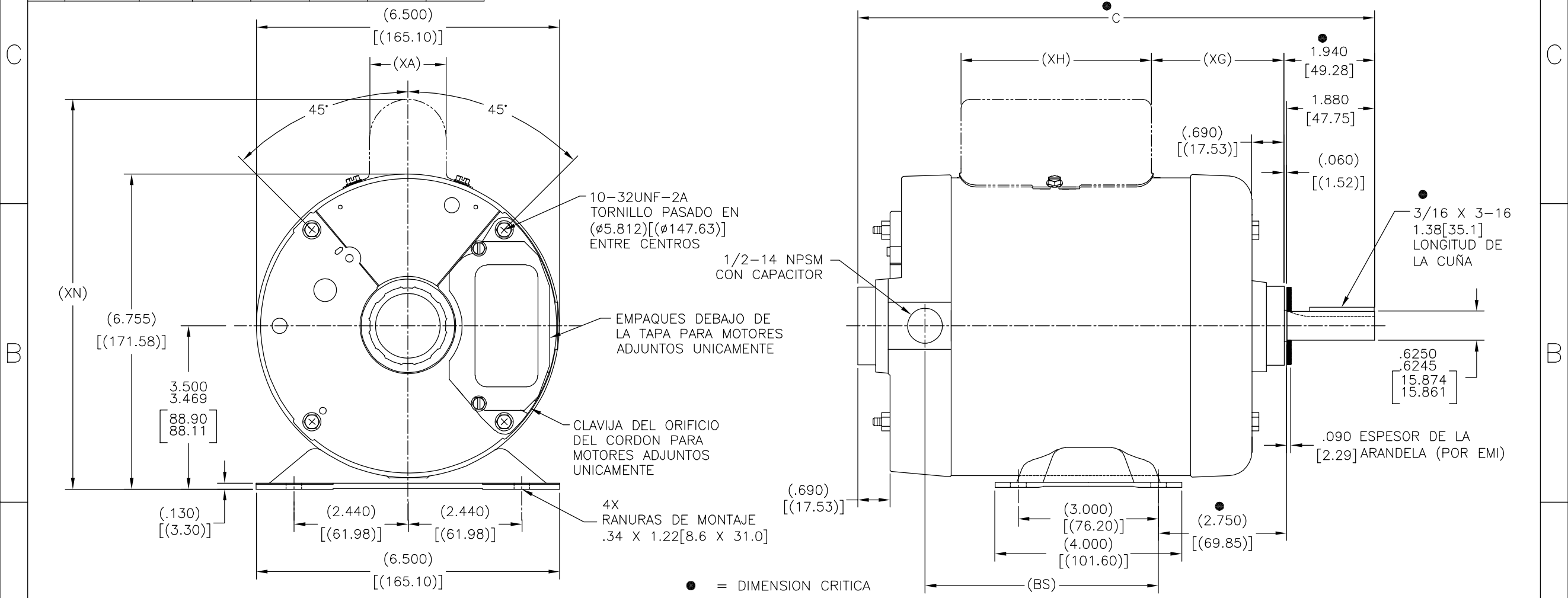

CARACTERISTICAS DE GEOMETRIA Y SIMBOLOS

- ∠ PLANICIDAD
- RECTITUD
- ∠ ANGULARIDAD
- ⊥ PERPENDICULARIDAD (A ESCUADRA)
- // PARALELISMO
- REDONDEZ (CIRCULARIDAD)
- ∅ CILINDRICIDAD
- △ PERFIL DE CUALQUIER SUPERFICIE
- ∧ PERFIL DE CUALQUIER LINEA
- ∩ VARIACION
- ⊕ POSICION REAL
- ⊙ CONCENTRICIDAD
- ≡ SIMETRIA

ASME Y14.5M 1994

A MENOS QUE SE ESPECIFIQUE DE OTRA MANERA, LAS TOLERANCIAS DE LAS DIMS; SON LAS SIGUIENTES:

PULG	±.1	±.02	±.005	±.0005
mm	±0.5	±0.13	±0.013	

ANG. ± 50 GRADOS  
ELIMINAR REBABAS Y ORILLAS FILOSAS DEL BORDE.  
PULG .003-.015 mm 0.1-0.4  
FILETEAR ESQUINA: PULG .020 mm 0.5  
MAQUINAR SUPERFICIES  
PULG 125 mm 3.2

DIMS METRICAS MOSTRADAS [PARENTESIS]

DIBUJADO POR:	
APROBADO POR:	
TERCER ANGULO DE PROYECCION	FECHA EDS: 11-11-2011 REV. FORMATO: H
CONFIDENCIAL: ESTE DIBUJO Y SU INFORMACION SON PROPIEDAD DE USO EXCLUSIVO Y CONFIDENCIAL DE REGAL-BELOIT CORPORATION. Y NO DEBERAN SER REVELADOS, DUPLICADOS, DISTRIBUIDOS O USARSE DE OTRA MANERA SIN EL CONSENTIMIENTO ESCRITO DE REGAL-BELOIT CORPORATION. -TODOS LOS DERECHOS RESERVADOS.	

**REGAL REGAL-BELOIT CORPORATION**

DESCRIPCION: MODEL-DC OUTLINE

TAMAÑO: C NUMERO DE DIBUJO: 114012

ESCALA: NONE HOJA: 1

4

3

2

1