

# PRODUCT INFORMATION PACKET



Model No: H966

Catalog No: H966

General Purpose Pump Motor, 3/4 HP, 3 Ph, 60 Hz, 575 V, 3600 RPM, J56J Frame, TEFC



Regal and Century are trademarks of Regal Rexnord Corporation or one of its affiliated companies.

©2022 Regal Rexnord Corporation, All Rights Reserved. MC017097E





**Nameplate Specifications**

Output HP	<b>3/4 Hp</b>	Output KW	<b>0.56 kW</b>
Frequency	<b>60 Hz</b>	Voltage	<b>575 V</b>
Current	<b>.92 A</b>	Speed	<b>3450 rpm</b>
Service Factor	<b>1</b>	Phase	<b>3</b>
Duty	<b>Continuous</b>	Insulation Class	<b>B</b>
Frame	<b>J56J</b>	Enclosure	<b>Totally Enclosed Fan Cooled</b>
Thermal Protection	<b>No Protection</b>	Ambient Temperature	<b>40 °C</b>
UL	<b>Recognized</b>	CSA	<b>Y</b>
CE	<b>N</b>	Number of Speeds	<b>1</b>

**Technical Specifications**

Electrical Type	<b>Polyphase, Induction Type, Single Or Dual Voltage</b>	Starting Method	<b>Across The Line</b>
Poles	<b>2</b>	Rotation	<b>Reversible Counterclockwise</b>
Mounting	<b>Round</b>	Drive End Bearing	<b>Ball</b>
Opp Drive End Bearing	<b>Ball</b>	Frame Material	<b>Rolled Steel</b>
Shaft Type	<b>Threaded</b>	Overall Length	<b>11.84 in</b>
Frame Length	<b>5.13 in</b>	Shaft Diameter	<b>0.625 in</b>
Shaft Extension	<b>2.57 in</b>		
Outline Drawing	<b>H966-S01</b>		

This is an uncontrolled document once printed or downloaded and is subject to change without notice. Date Created:11/28/2022

TYPE	FRAME
SC	J56J

NOTES:

- 1. PILOT DIAMETER IS CONCENTRIC WITH SHAFT CENTERLINE WITHIN .004[.102] T.I.R.
- 2. FACE OF MOUNTING FLANGE IS PERPENDICULAR TO SHAFT CENTERLINE WITHIN .004[.102] T.I.R.
- 3. SHAFT RUNOUT NOT TO EXCEED .002[.051] T.I.R.
- 4. FOR THREADED SHAFT EXT. (56J) MATING PARTS SHOULD BE RELIEVED ONE THREAD TO CLEAR FILLET.
- 5. FOR THREADED SHAFT EXT. (56J) ECCENTRICITY OF THREADED PORTION OF SHAFT IS HELD WITHIN .004[.102] TOTAL GAGE READING WITH THE INDICATOR ON O.D. OF GROUND RING GAGE AS SHOWN. THE GAGE BEING STATIONARY WITH RESPECT TO THE ROTOR.
- 6. END PLAY NOT TO EXCEED .010[.254] MEASURED WITH NO THRUST.
- 7. ALL DIMENSIONS SHOWN IN PARENTHESIS ARE REFERENCE DIMENSIONS.

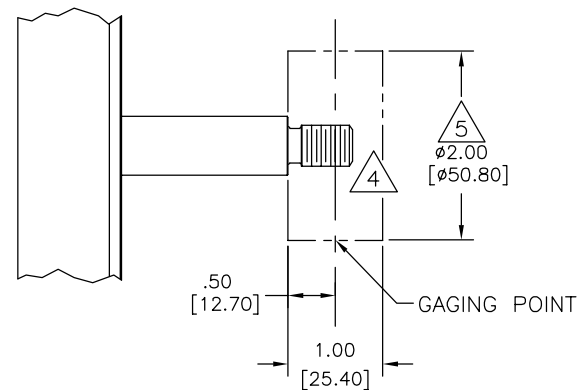
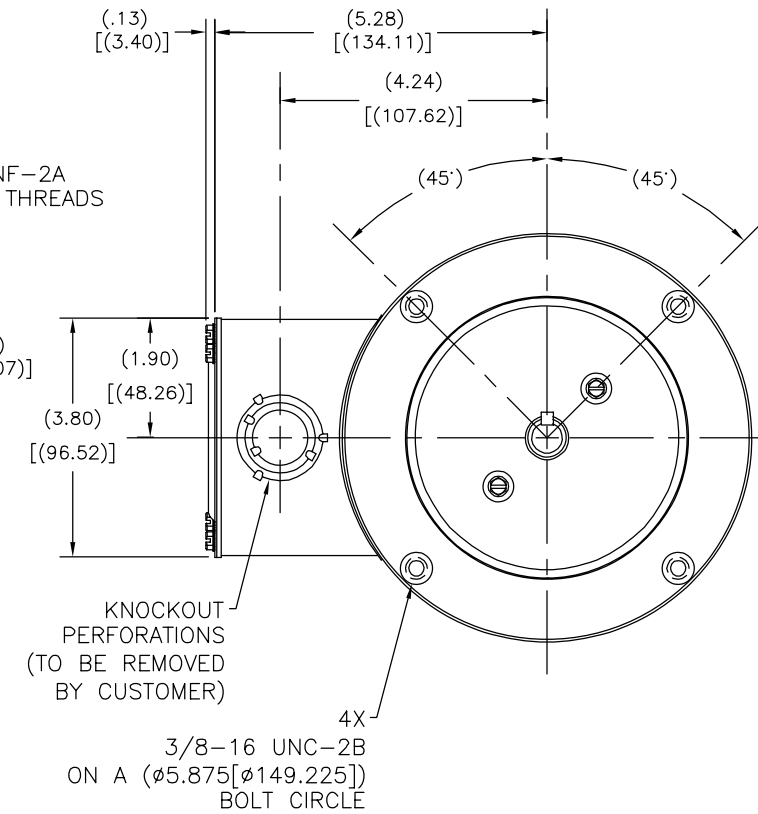
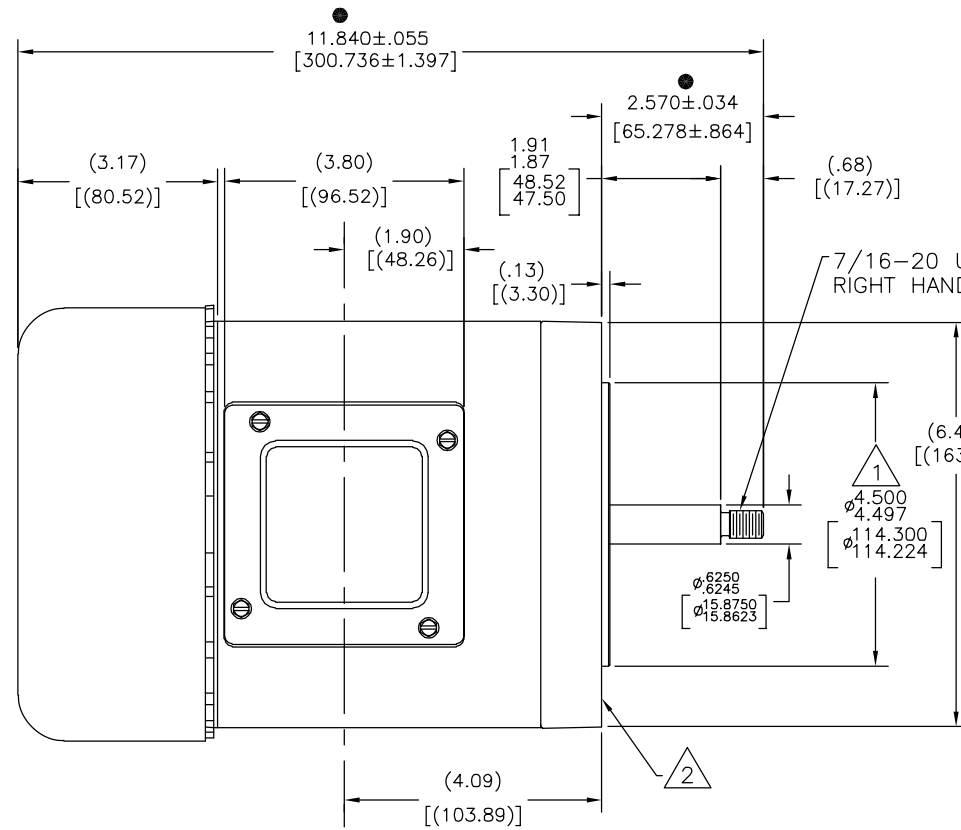
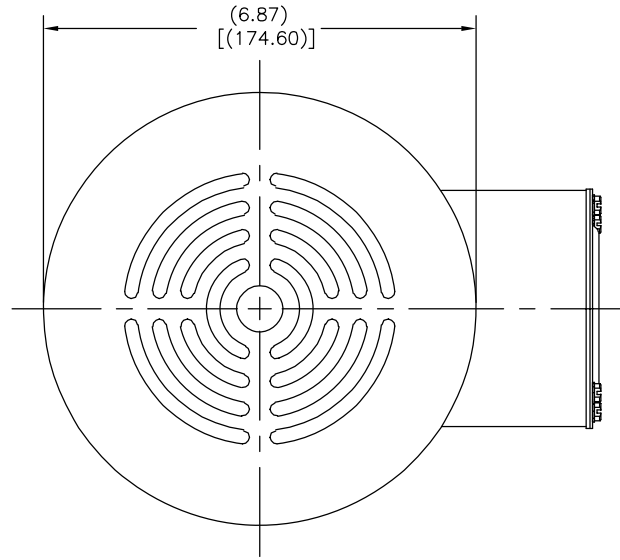

● = CRITICAL DIMENSION

DRAWING REVISION A	REVISION BY J.C. ESTRADA	DATE 3-31-2014	TOLERANCES UNLESS OTHERWISE SPECIFIED DEC. INCH mm ANGLE .X ±0.1 [±2.5] ±0.5° .XX ±0.02 [±0.51] .XXX ±0.005 [±0.127] .XXXX ±0.0005 [±0.0127]	DRAWN BY: DAVHOL	Regal Beloit America, Inc.
ECO 0048571	APPROVED BY F. PAYAN	DATE 3-31-2014	REMOVE BURRS & BREAK SHARP EDGES .003(.015) L.076(.381) CORNER/FILLETS .02 (.51) MACHINED SURFACES .125 INCH / 3.2 mm SHOWN IN [BRACKETS]	DATE: 10-13-1999	
ECO DESCRIPTION SEE MODEL NUMBER				APPROVED BY:	MATERIAL
<small>COPYRIGHT REGAL BELOIT AMERICA, INC. ALL RIGHTS RESERVED. PROPRIETARY AND CONFIDENTIAL INFORMATION - THIS DOCUMENT IS THE PROPERTY OF REGAL BELOIT AMERICA, INC. (OWNER) AND CONTAINS OWNER'S PROPRIETARY INFORMATION. ANY PERSON, CORPORATION OR OTHER FIRM RECEIVING IT IS DEEMED, BY RECEIVING IT, TO AGREE THAT IT, AND/OR ANY PART OF IT, SHALL NOT BE DISCLOSED TO ANY PERSON, CORPORATION OR OTHER ENTITY, DUPLICATED, AND/OR USED, EXCEPT AS EXPRESSLY APPROVED IN WRITING IN ADVANCE BY OWNER. THIS DOCUMENT SHALL BE RETURNED TO OWNER UPON REQUEST. IT MAY BE SUBJECT TO CERTAIN RESTRICTIONS UNDER APPLICABLE EXPORT CONTROL LAWS AND REGULATIONS.</small>				DATE:	SIZE DWG NO H966
				PROCESS/FINISH	SHEET 1
				THIRD ANGLE PROJECTION	